



ENVIRONMENTAL PROTECTION ACT 1990
SECTION 37

WASTE MANAGEMENT LICENCE
NOTICE OF MODIFICATION

Agency Ref No: 23680 LICENCE REF No: WML/308	FACILITY TYPE: A11
LICENCE HOLDER:	LICENSED FACILITY:
P Bialek Ltd St. Thomas' Farm London Road Laverstock Salisbury Wiltshire SP1 3YV	C B Skips St Thomas' Farm London Road Laverstock Salisbury Wiltshire SP1 3YU

WHEREAS you are the licence holder of the said licensed facility

AND WHEREAS on the 1st April 1996 the powers and duties of all waste regulation authorities in England and Wales transferred to the Environment Agency ("the Agency") by virtue of section 2 of the Environment Act 1995

AND WHEREAS the conditions of the said licence may have been modified from time to time

NOTICE IS HEREBY GIVEN that the Agency modifies the conditions of the said licence in accordance with Section 37(1)(a) of the Environmental Protection Act 1990 and as set out in the Schedule attached to this notice.

Signed Adam Davis
Dated 09 December 2003

Name ADAM DAVIS
Job Title ENVIRONMENT MANAGEMENT
TEAM LEADER.

This modification shall take immediate effect.

YOUR ATTENTION IS DRAWN TO THE RIGHTS OF APPEAL DETAILED AT THE END OF THIS MODIFICATION.



SCHEDULE – CONDITIONS RELATING TO THIS MODIFICATION

Modification of conditions under section 37(1)(a) of the Environmental Protection Act 1990 as follows:

Whereas the licence had a condition requiring financial provision to be made and/or maintained, this condition shall now be deleted.

EXPLANATORY NOTES - including rights of appeal.

RIGHTS OF APPEAL

Section 43(1) of the Environmental Protection Act 1990 provides that:

Where, except in pursuance of a direction given by the Secretary of State, the conditions of a licence are modified, the licence holder may appeal from the decision to the Secretary of State.

Therefore, if you feel aggrieved by the decision detailed on the attached notice, you may obtain the appropriate form on which to give written notice of an appeal from :-

The Planning Inspectorate
Room 4/19 Eagle Wing
Temple Quay House
2 The Square
Temple Quay
Bristol
BS1 6PN

Tel: 0117 372 8812
Fax: 0117 372 6093

For Wales, the address is –
The Planning Inspectorate
Crown Buildings
Cathays Park
Cardiff
CF10 3NQ

Tel: 02920 823859
Fax: 02920 825150

This notice of appeal should be accompanied by the following information:

- A statement of the grounds of appeal;
- A copy of any application to modify the licence
- A copy of the licence;
- A copy of any correspondence relevant to the appeal;
- A copy of any other document relevant to the appeal including, in particular, any relevant consent, determination, notice, planning permission, established use certificate or certificate of lawful use or development and
- A statement indicating whether you wish the appeal to be in the form of a hearing or on the basis of written representations.

You are also required to serve a copy of your notice of appeal, together with copies of any the above documents that have accompanied your notice of appeal, on the Environment Agency (at the address overleaf). You should appeal within 6 months of the date that this notice takes effect but the Secretary of State may allow notice of appeal to be given after the expiry of this time period.

Variation notice with introductory note

Environmental Permitting (England & Wales) Regulations 2007

C B Skips

C. Bialek Limited
St. Thomas' Farm
London Road
Laverstock
Salisbury
Wiltshire
SP1 3YU

Variation notice number
EPR/XP3393FX/V003

Permit number
EPR/XP3393FX

C B Skips

Permit Number EPR/XP3393FX

Introductory note

This introductory note does not form a part of the permit

The following notice, which is issued pursuant to regulation 20 and Part 1 of Schedule 5 of the Environmental Permitting (England and Wales) Regulations S.I.2007 No. 3538 (the Regulations), gives notice of the variation of an environmental permit to operate a regulated facility.

This is a change to company name from P. Bialek Limited to C. Bialek Limited due to Environment Agency administrative error on previous modifications.

Schedule 1 of this notice lists any deleted conditions, Schedule 2 lists any amended conditions and Schedule 3 lists any conditions that have been added.

Status Log of the permit		
Detail	Date	Response Date
Original licence issued	25/06/1997	
Modification issued	28/04/2000	
Modification issued	09/12/2003	
Variation EPR/XP3393FX issued	23/04/2009	

End of Introductory Note

Notice of variation

Environmental Permitting
(England and Wales) Regulations 2007

Permit number

EPR/XP3393FX

The Environment Agency in exercise of its powers under Regulation 20 of the Environmental Permitting (England and Wales) Regulations 2007 (SI 2000 No 3538) varies the permit as set out below.

C. Bialek Limited ("the operator"),

whose registered office is

St. Thomas' Farm

London Road

Salisbury

Wiltshire

SP1 3YU

company registration number 00725936

holds a permit to operate a regulated facility at

St. Thomas' Farm

London Road

Laverstock

Salisbury

Wiltshire

SP1 3YU

and that permit is varied to the extent set out in Schedules 1 to 3 of this notice.

The notice shall take effect from 23 April 2009

Name	Date
	23 April 2009

Authorised on behalf of the Agency

Schedule 1 – conditions to be deleted

1. None

Schedule 2 – conditions to be amended

2. None

Schedule 3 – conditions to be added

3. None



ENVIRONMENT
AGENCY

ENVIRONMENTAL PROTECTION ACT 1990
ENDORSEMENT TO WASTE MANAGEMENT LICENCE

LICENCE REF No :- WML/308 FACILITY TYPE:-WASTE TRANSFER STATION

The Environment Agency, in pursuance of its powers under Section 37(1) of the Environmental Protection Act 1990, hereby varies the conditions attached to this notice of the waste management licence reference number WML/308 which was issued to P. BIALEK LTD AT ST. THOMAS' FARM, SALISBURY, WILTSHIRE, SP1 3YU on the 25 June 1997, authorising the KEEPING AND TREATING of controlled waste on the land at ST. THOMAS' FARM.

Signed Adam Davis Name ADAM DAVIS
(Area Environmental Planning Manager - South Wessex)

Dated 28-APRIL-2000

This variation shall take effect from 28-APRIL 2000.

FOR ENVIRONMENT AGENCY OFFICIAL USE ONLY

**PUBLIC REGISTER
COPY**



Condition 4.1 shall be modified to read as follows:-

A summary record of the waste types accepted and removed from the site shall be made for each quarter of the financial year and shall be submitted to the Agency within 1 month following the end of the quarter. The record shall be in a format agreed with the Agency.

Condition 8.3.1 to 8.3.5 (inclusive) shall be removed.

Condition 8.3.6 shall be modified to read as follows:-

Area (B) as detailed in drawing number WP/2000/1 of the working plan dated February 2000 shall be constructed, inspected, validated and maintained, and shall be fully documented and recorded, to be fit for purpose, and to meet the standards specified below.

a) Impermeable pavement, bunding and sills	i) Areas of impermeable pavement, bunding and sills shall be constructed and maintained so as to prevent fluids running off the pavement and the transmission of fluids through the pavement or joints.
	ii) Areas of impermeable pavement shall be: <ul style="list-style-type: none">• laid to take the weight of relevant vehicles, plant and equipment without cracking or breaking; and• free from cracks which could reduce impermeability; and• resistant to mechanical, physical and chemical stresses to which they may be subjected; and• fall towards the drainage system to prevent ponding.
	iii) No liquid shall run off areas of impermeable pavement other than via the drainage system.
	iv) Timber sleeper containment walls shall be constructed along the edge of area (B) in accordance with section 5.1(i) of the working plan dated February 2000.

b) Drainage systems	i) Drainage for area (B) shall be via a silt trap and an oil interceptor to a soakaway in accordance with section 10 of the working plan dated February 2000 and drawing WP/2000/2. The silt trap and the oil interceptor shall be maintained in good working order at all times.
	ii) Drainage for area (F) shall be to a sealed tank.
	iii) Drainage for the vehicle washing area, as indicated on drawing WP/2000/1 and dated February 2000 of the working plan, shall be to a sealed tank.
	iv) Uncontaminated roof water and drainage from clean yard areas shall be kept separate and discharged to a soakaway.

Condition 8.3.8 shall be modified to read as follows:-

The perimeter of indoor containment bay D, D2 and D3 shall be constructed and maintained to meet the specification of section 5.1 (ii) of the working plan. No changes shall be made to this part of the working plan without the prior written consent of the Agency.

Condition 9.2 shall be modified to read as follows:-

All wastes shall be inspected, accepted or rejected, received or despatched, handled, kept and recorded in accordance with section 6 of the working plan and with the standards specified in the Table below.

Standards for waste acceptance and control procedures

Stage of Waste Handling	Specified standards
a) Waste inspection and acceptance	<p>All wastes received at the site:</p> <ul style="list-style-type: none">i) shall be inspected on receipt to confirm their description and composition against the relevant waste transfer note and other accompanying documentation for compliance.ii) shall be kept separate from and shall not be covered by or mixed with other wastes until they have been confirmed and recorded for acceptance at the site.iii) shall first be directed to reception hall C or contained within skips in area (F) in accordance with section 6 of the working plan, after confirmation of its conformance with its accompanying documentation.
b) Waste storage	<ul style="list-style-type: none">i) Waste shall only be handled or placed on concrete hardstanding in area (B), reception hall (C), bays (D), (D2) and (D3) or contained within skips in area F in accordance with drawing number WP/2000/1 and dated February 2000 of the Working Plan.ii) With the exception of sorted soils and hardcore stored directly on the ground in area (B), all wastes shall be stored in containment bays or skips by the end of the working day.iii) Area (G) shall be used only for the storage of empty skips.
c) Quarantine storage and rejection of wastes	<ul style="list-style-type: none">iv) Any items of non-permitted waste which are detected after acceptance at the site of the wastes in which they were included, shall be placed immediately in a designated quarantine storage area, bay or container, and, where these are or appear to be special wastes, the Agency shall be informed immediately;v) In the quarantine area, wastes shall be kept segregated from other wastes which are or are likely to be incompatible;vi) Quarantined wastes shall be removed from site within 7 days;vii) The maximum capacity of the quarantine storage facility shall be 5 m³.viii) A non-conformance record (including actions taken) shall be kept in the site diary of all rejected wastes.
d) Identification of wastes	<ul style="list-style-type: none">i) Areas and bays shall be clearly defined to identify the wastes stored within them.
e) Inspection of wastes for despatch	<ul style="list-style-type: none">i) All wastes despatched from the site shall be inspected prior to despatch to confirm their description and composition.

Condition 9.3 shall be removed.

Condition 9.6 shall be removed.

COPY

c B skips



ENVIRONMENT AGENCY

**ENVIRONMENTAL PROTECTION ACT 1990
WASTE MANAGEMENT LICENCE**

LICENCE REF No:- WML/308 FACILITY TYPE:WASTE TRANSFER STATION

The Environment Agency, in pursuance of Part II of the Environmental Protection Act 1990, hereby grant a waste management licence authorising the KEEPING AND TREATING of controlled waste on the land specified in Schedule 1 to this licence to P. BIALEK LTD AT ST. THOMAS' FARM, SALISBURY, WILTSHIRE, SP1 3YU that person being in occupation of the said land, the said licence being subject to the conditions specified in Schedule 3 to this licence.

In this licence the words and expressions contained in Schedule 2 shall have the meaning assigned to them therein.

SCHEDULE 1 - SPECIFIED LAND

The licence relates to the land at ST. THOMAS' FARM (hereinafter called "the site") shown hatched black on Drawing Reference Number S182/001 and dated June 1997, and attached to this licence.

Signed H.T. Davidson
(Area Manager - South Wessex)

Name H.T. DAVIDSON

Dated 25th June 1997

FOR ENVIRONMENT AGENCY OFFICIAL USE ONLY	PUBLIC REGISTER COPY
--	---------------------------------

**YOUR ATTENTION IS DRAWN TO THE RIGHTS OF APPEAL DETAILED
IN THE NOTES AT THE END OF THIS LICENCE**

Environment Agency, Rivers House, Sunrise Business Park, Higher Shaftesbury Road, Blandford Forum, Dorset DT11 8ST.



Y903

SCHEDULE 2 - DEFINITIONS

the 1990 Act - the Environmental Protection Act 1990.

the 1995 Act - the Environment Act 1995.

the Agency - the Environment Agency.

the Agency's emergency telephone number - 0800 80 70 60 or such other number as from time to time is notified to the holder.

Clinical waste - as defined in Regulation 1(2) of the Controlled Waste Regulations 1992 (S.I. 1992 No.588) or any statutory provisions or regulations amending or replacing them.

the Conditions of this licence - the conditions set out herein, as varied from time to time under Section 37 of the 1990 Act and section 120 of the 1995 Act.

Controlled waste - as defined in section 75(4) of the 1990 Act and Regulations 7A of the Controlled Waste Regulations 1992 or any statutory provisions or regulations amending or replacing them.

Emergency - means a situation in which a person has reasonable cause to believe that circumstances are likely to endanger life or health or cause damage to property or pollution of the environment or could be seriously detrimental to the amenities of the locality.

the holder - the licence holder specified in this licence or other person to whom the licence has been transferred in accordance with section 40 of the 1990 Act and section 120 of the 1995 Act.

Hardstanding - hardstandings are distinguished from impermeable pavements. A hardstanding of high specification may be deliberately given an upper layer that is permeable: this speeds the clearance of rainwater from the surface of percolation.

Hours of Darkness - are defined by statutory lighting up times published by the Science Engineering Research Council.

Impermeable pavement - this is a pavement constructed and maintained to a standard sufficient to prevent the transmission of liquid through the pavement surface.

Level, Levels, Levelled, Levelling - when used in connection with height measurement, refers to a vertical measurement related to Ordnance Datum quoted to an accuracy of ± 0.01 metres, unless otherwise stated.

NAMAS - National Accreditation of Measurement & Sampling.

Officer - shall mean any person authorised in writing by the Agency, pursuant to Section 68 of the Environmental Protection Act, 1990, to carry out functions conferred upon the Authority by Section 69 and 70 of the same Act.

Public Register
COPY

Relevant Offences - within the meaning of regulation 3 of the Waste Management Licensing Regulations 1994 (S.I. 1994 No.1056) or any statutory provisions or regulations amending or replacing them.

Sealed Drainage System - this discharges either to an oil interceptor or to a sealed sump and thence to an approved discharge. An approved discharge may be sewer, a watercourse, or a soakaway. For a discharge to sewer the operation must have prior consent of the sewerage undertaking. For a discharge to a watercourse or a soakaway, the operator must have prior consent of the Agency.

the site - the land, structures, plant and equipment to which this licence relates.

the site plan - the drawing referred to in Schedule 1 of this licence.

Special waste - as defined by The Special Waste Regulations 1996 S.I. 1996 No.972 or regulations amending or replacing them.

Technically competent person - within the meaning of regulations 4 and 5 of the Waste Management Licensing Regulations 1994 (S.I. 1994 No.1056) or any statutory provisions or regulations amending or replacing them.

UKAS - United Kingdom Accreditation Service.

Working Plan - the documents and drawings detailing the intended methods of operations for this licence and any later drawings or written statements received by the Agency in substitution or augmentation of such drawings or documents subject to individual changes having been agreed by the Agency where this licence so requires.

SCHEDULE 3 - CONDITIONS

1.0 GENERAL

- 1.1 Any authorisations or agreements required by this licence shall only be given in writing by the Environment Agency (Agency). Notifications required by this licence shall be in writing from the licence holder. If these conditions are not fulfilled none of the above are deemed valid.
- 1.2 The terms of this licence and the details set out in the Working Plan shall be made known to any person who is involved in the operation of the site. Copies of these documents shall be displayed at the site office or at location(s) agreed with the Agency.

2.0 PERMITTED PROCESSES

- 2.1 This licence authorises the following operations:

The keeping and transfer of wastes by mechanical plant of less than 35,000 tonnes per annum. This does not include mechanical separation or treatment of wastes.

3.0 PERMITTED WASTES

- 3.1 Only the types of wastes detailed in Appendix I shall be kept or transferred within the site.

4.0 RECORDS

- 4.1 A record of the types and quantities of waste disposed of at the site shall be kept. The record shall be made available for inspection by the Agency at any reasonable time and a summary shall be forwarded to the Agency on the form attached as Appendix II of this licence (or in any other format agreed with the Agency) on the second Tuesday of every month.
- 4.2 A site diary shall be maintained on site to record significant dates and events in the operation of the site. Records shall include as a minimum:

Environmental problems and remedial actions (e.g. smell, noise, pollution problems)

Special wastes delivered, accidents, spillages, fires

Emergencies and action taken

Vermin inspections and any action taken

Problems with waste received and any action taken

Repairs to site roads and other structures.

Breaches of security leading to problems on site.

Agreements given by the Agency which require immediate action. Any agreement detailed in the site diary and endorsed with the signature of a Agency officer shall be regarded as a written agreement.

4.3 The site diary shall be made available for inspection by the Agency at any reasonable time.

5.0 WORKING PLAN

A Working Plan shall be prepared by the licence holder and submitted to the Agency prior to the commencement of site operations. Thereafter the Working Plan shall be reviewed by the licence holder to take into account contemporary waste management practice and advice. When an updated Working Plan is submitted to the Agency by the licence holder it shall supersede all previous Working Plans.

5.1 Where licence conditions refer to details in the Working Plan, it shall be only the current Working Plan that is applicable. All operations shall take place in accordance with the Working Plan and the licence holder shall submit details of any changes to the operations to the Agency for their agreement prior to their implementation. Documents and drawings submitted as part of the Working Plan shall form part of this licence when referenced to a specific licence condition.

5.2 The Working Plan shall detail the following:-

Preparatory site works and design

Site layout

The methods of construction and position of site access

Site security measures including fencing, gates and staffing arrangements

Methods of handling and storing waste

The method of working the site

The staffing level of the site with details of qualifications and experience of staff and their responsibilities

The hours of opening and operation

The plant and equipment to be used

The anticipated annual input of waste

Dust control measures

Litter control measures

Noise control measures

Vermin and fly control measures

Procedures for the temporary storage and disposal arrangements for unpermitted wastes delivered to the site including details of the location of the storage area

6.0 SITE STAFFING

- 6.1 The site shall be staffed by suitably trained persons and supervised by a Technically Competent Person. The licence holder shall provide the Agency with the name(s), job title(s), responsibilities and details of experience of the person(s) they consider to be the Technically Competent Management at the site, for approval. The licence holder shall notify the Agency within five working days of any changes in the management of the site.
- 6.2 A member of staff who is familiar with the conditions of this licence shall inspect the wastes as they are deposited and shall contact the technically competent person in the event of unpermitted waste being deposited.

7.0 SECURITY AND SIGNS

- 7.1 The site shall be provided with gates and fencing suitable to prevent unauthorised access and the unauthorised deposit of waste. All entrances to the site shall be provided with gates capable of being locked. In the event that unauthorised access takes place which leads to interference with the site operation, or the deposit of waste, appropriate additional security measures as notified to the Agency shall be taken. The site gates shall be locked closed when staff are not present on site.
- 7.2 A site identification board shall be displayed in a prominent position at the site entrance. The identification board shall include the following details:

The name of the site

The name of the site licence holder

Waste Transfer Station, St Thomas' Farm, Laverstock, Salisbury
WML/308

The Waste Management Licence number for the site
The licence holder's emergency contact and telephone number

"This site is licensed under the Environmental Protection Act 1990 by:

Environment Agency
Rivers House
Sunrise Business Park
Blandford Forum
Dorset
DT11 8ST
Tel: 01258 456080
or 0800 80 70 60 out of hours"

8.0 SITE PREPARATION

- 8.1 Fuel tanks shall be surrounded by an impermeable bund providing a capacity not less than 110% of the capacity of the tank it surrounds and this shall be maintained to provide an available capacity of at least 105%. The bund shall not incorporate any drains. Hoses used for refuelling shall be hung with the outlet inside the bund. Any taps or valves shall be locked closed when not in use.
- 8.2 The transfer areas shall be located as in Drawing No. S182/002.
- 8.3 The waste transfer areas shall be constructed in accordance with the following requirements.

Outdoor Containment Bay (A)

- 8.3.1 Outdoor containment bay (A) shall be surfaced with an impermeable pavement of concrete featuring a raised perimeter and shall be provided with a drainage system or shall be provided with a roof covering this area. If a roof is provided and maintained conditions 8.3.2 and 8.3.3 shall cease to have effect.
- 8.3.2 The falls on the impermeable pavement shall be such that surface water from the bay enters the drainage system.
- 8.3.3 The drainage system shall be constructed so that it only empties to a sealed tank, the capacity of which shall be agreed with the Agency prior to the issue of this licence.
- 8.3.4 The perimeter of the bay shall be surrounded on three sides by a wall 2 metres in height. The wall shall have a concrete base and be constructed

and maintained with materials able to withstand any reasonable pressure exerted on it.

- 8.3.5 A road hump feature shall be constructed on the front edge of the bay to prevent the egress of any spillages which may occur.

Area (B)

See mod.

- 8.3.6 Area (B) shall be surfaced with an impermeable pavement of concrete featuring a raised perimeter and shall be drained via a silt trap to a soakaway. The falls on the impermeable pavement shall be such that surface water from this area enters the drainage system. The silt trap and soakaway shall be maintained in good working order at all times.

Reception Hall (C)

- 8.3.7 Reception hall (C) shall be a roofed structure. The floor of the reception hall (C) shall be surfaced with an impermeable pavement of concrete. A road hump feature shall be constructed on the front edge of the reception hall to prevent the egress of any spillages which may occur.

Indoor Containment Bay (D)

- 8.3.8 The perimeter of indoor containment bay (D) shall be surrounded on three sides by a wall 2 metres in height. The wall shall have a concrete base and be constructed and maintained with materials able to withstand any reasonable pressure exerted on it.

Area (F)

- 8.3.9 Area (F) shall be surfaced with an impermeable pavement of concrete featuring a raised perimeter and shall be provided with a drainage system or shall be provided with a roof covering this area. If a roof is provided and maintained, conditions 8.3.10 and 8.3.11 shall cease to have effect.
- 8.3.10 The falls on the impermeable pavement shall be such that surface water from Area (F) enters the drainage system.
- 8.3.11 The drainage system shall be constructed so that it only empties to a sealed tank, the capacity of which shall be agreed with the Agency prior to the issue of this licence.
- 8.3.12 A road hump feature shall be constructed around the perimeter of Area (F) to prevent the egress of any spillages which may occur.

Area (G)

8.3.13 Area (G) shall be restricted to the storage of empty skips only.

8.4 The transfer areas must be prepared by providing the infrastructure required by the conditions of this licence prior to the transfer of any wastes on site.

8.5 The site preparation must be agreed as complete by the Agency prior to the transfer of any wastes on site.

9.0 SITE OPERATION

9.1 Waste shall only be deposited and transferred within the following areas located in Drawing No. S182/002.

See Mod
9.2 Waste arriving at the site shall only be deposited directly on the ground within containment bays (A) and (D) as defined on Drawing No. S182/002.

9.3 Wastes shall only be kept in the areas of containment bay (A), concrete hardstanding (B), reception hall (C) or contained within skips on Area (F) as defined on Drawing No. S182/002.

9.4 Only clean soils and hardcore recovered after sorting shall be permitted on concrete hardstanding (B). The maximum quantity of soils and hardcore that may be stored on this area at any one time shall be limited to 100 cubic metres.

9.5 All skips containing wastes must be kept on Area (F).

9.6 All wastes shall be stored in containment bays or skips by the end of the working day, with the exception of clean soils and hardcore which may be left on Area (B).

9.7 The maximum quantity of wastes that may be stored on site at any one time shall be limited to 200 cubic metres.

9.8 When skips are full they shall be moved off site within 48 hours and waste storage bays shall be cleared of waste at least once every 48 hours.

Waste Transfer Station, St Thomas' Farm, Laverstock, Salisbury
WML/308

9.9 Site operations shall only be carried out during the following hours:

Monday to Friday (inclusive)	0800 - 1800 hours
Saturdays	0800 - 1300 hours
Sundays & Bank Holidays	No operation

Any operation outside these hours must be proposed and agreed in writing prior to the operation by the Agency.

- 9.10 Each load arriving at the site shall be inspected before receipt and after emptying of the skips. Any unpermitted waste shall be removed immediately and shall be either placed in a secure container or taken off site immediately for disposal at a suitably licensed site.
- 9.11 The licence holder shall provide a supply of suitable absorbent material to be kept in a safe and accessible location on the site.
- 9.12 In the event that liquid waste should be spilt from a consignment of waste being brought in, suitable absorbent material shall be used immediately.
- 9.13 All vehicles and containers holding waste, using or being parked on the site other than in the course of unloading, shall be adequately covered if there is a risk of any of the contents spilling out or being blown away. No liquor shall be allowed to collect in or discharge from any container holding waste.
- 9.14 The site shall be maintained in a tidy condition. Any litter or loose waste from around the site shall be collected immediately and bagged for disposal.
- 9.15 Measures shall be taken to prevent mud or other debris from the site from reaching the public highway.
- 9.16 Access roads shall be maintained in good condition, free from ruts, potholes, mud and standing water.
- 9.17 The licence holder shall ensure that the site is inspected weekly for the presence of rodents. Immediate steps shall be taken to eliminate any rodents found within the confines of the site. The date of the inspections, together with any action taken, shall be recorded in the site diary/log book.
- 9.18 The licence holder shall ensure that insect infestations are prevented at the site. No insecticides are to be stored at the site.
- 9.19 Any waste deposited outside of the site gates or on the access road shall be removed immediately on opening the site.

- 9.20 All plant and machinery shall be properly operated and maintained so as to prevent disturbance from noise and fumes.
- 9.21 Precautions shall be taken to avoid nuisance from the generation of airborne dust on the site. At times when airborne dust is likely to be generated the following steps shall be taken:
- i) Vehicle speeds be reduced.
 - ii) Site roads and dusty areas be wetted with water.
- 9.22 If dust arising from the transfer or storage of waste can be visibly detected leaving the confines of the site, the transfer operation shall cease immediately and remedial measures such as reducing vehicle movements and spraying the area with water shall also be taken immediately. Transfer operations shall not recommence until no dust can be visibly detected leaving the confines of the site.
- 9.23 No waste shall be burnt within the boundaries of the site and a fire at the site shall be regarded as an emergency and immediate action shall be taken to extinguish it. All outbreaks of fire shall be notified forthwith to the Agency and details of the incident shall be recorded in the site diary.
- 9.24 In the event of any occurrences likely to lead to pollution of the environment or harm to human health, the licence holder must inform the Agency immediately. If a load is suspected to contain Special Waste the incident shall be reported immediately to the Agency by giving details of the waste, company delivering, registration mark of the vehicle and name of the driver. A waste rejection note shall be completed containing the above information and shall be retained with the site diary.

10.0 FINANCIAL PROVISION

- 10.1 No activities authorised by this Licence shall be commenced until the holder has made financial provision adequate to discharge the obligations arising from this Licence and that provision has been accepted in writing by the Agency.
- 10.2 The financial provision accepted under 10.1 above shall be maintained by the holder from the date of the acceptance by the Agency throughout the subsistence of this licence and the holder shall produce evidence of such provision whenever required by the Agency.

14

1198 8

1-

6 15

457223

APPENDIX 1

WASTE CATEGORY A:

AUTHORISED

Naturally occurring and manufactured material for which the environmental impact of deposition is less than or comparable with that of topsoil. It does not contain substances other than those of the types included in the list below.

Soil
Rock
Stone
Clay
Sand
Brick Bats
Slates
Uncoated clay-based tiles

WASTE CATEGORY B:

AUTHORISED

Material only slightly soluble in water but because of its origin may be contaminated with material of low polluting potential. It does not contain substances other than those of the types included in the list below:

Brickwork and concrete (hardcore)
Weathered/excavated coated roadstone (tarmac and bitumac)
'Fresh' coated roadstone (tarmac and bitumac)
Weathered/excavated cement and cement products
Glass, pottery, ceramics, china, enamels (baked and finished products) and mica
Silica
Plastics (as finished products or manufacturing scrap)
Metal
Man made fibres (excluding asbestos or bonded asbestos)
Plasterboard
Garden, arboricultural, botanical, aquacultural and horticultural waste (excluding chemicals)
Wood, wood products and wood based processing wastes
Leather
Natural fibres
Rubber granules and fragments
Packaging, absorbents, wiping cloths, filter materials, protective clothing

EXCLUSIONS

Wastes included in Categories A and B are not permitted if they:

- a) are mixed with or contaminated with any materials other than those listed in Category A or B above or substances that would render them special wastes under The Special Waste Regulations 1996.
- b) are in sludge or liquid form (not self supporting)
- c) are in a dust, ash, powdered or particulate form, and are likely to cause airborne nuisance or hazard unless suitable handling means or packaging is used.

ENVIRONMENT AGENCY **APPENDIX II**
WASTE MANAGEMENT
MONTHLY RECORD OF WASTE - TRANSFER STATIONS

SITE.....
.....
.....

WASTE MANAGEMENT
LICENCE NUMBER...../.....

MONTH/YEAR...../.....

WASTE TYPE (WEIGHT IN TONNES OR Volume in cubic metres)

Origin of waste	No. of Deliveries	Biodegradable Waste (general refuse)	Excavated Waste e.g Soils	Construction & Demolition Waste (includes plaster board, wood etc.)	Green Waste
From Inside South Wessex Area					
From Outside South Wessex Area (Please state county of origin)					
Disposed of					
Disposal Site (name)					
Waste Recycled					
TOTAL					

Please return completed forms to: Tessa Bowering, The Environment Agency, Waste Management, Rivers House, Sunrise Business Park, Higher Shaftesbury Road, Blandford Forum, Dorset, DT11 8ST. (Tel. 01258 456080).

The South Wessex Area consists of Dorset and the Kennet and Salisbury districts of Wiltshire.

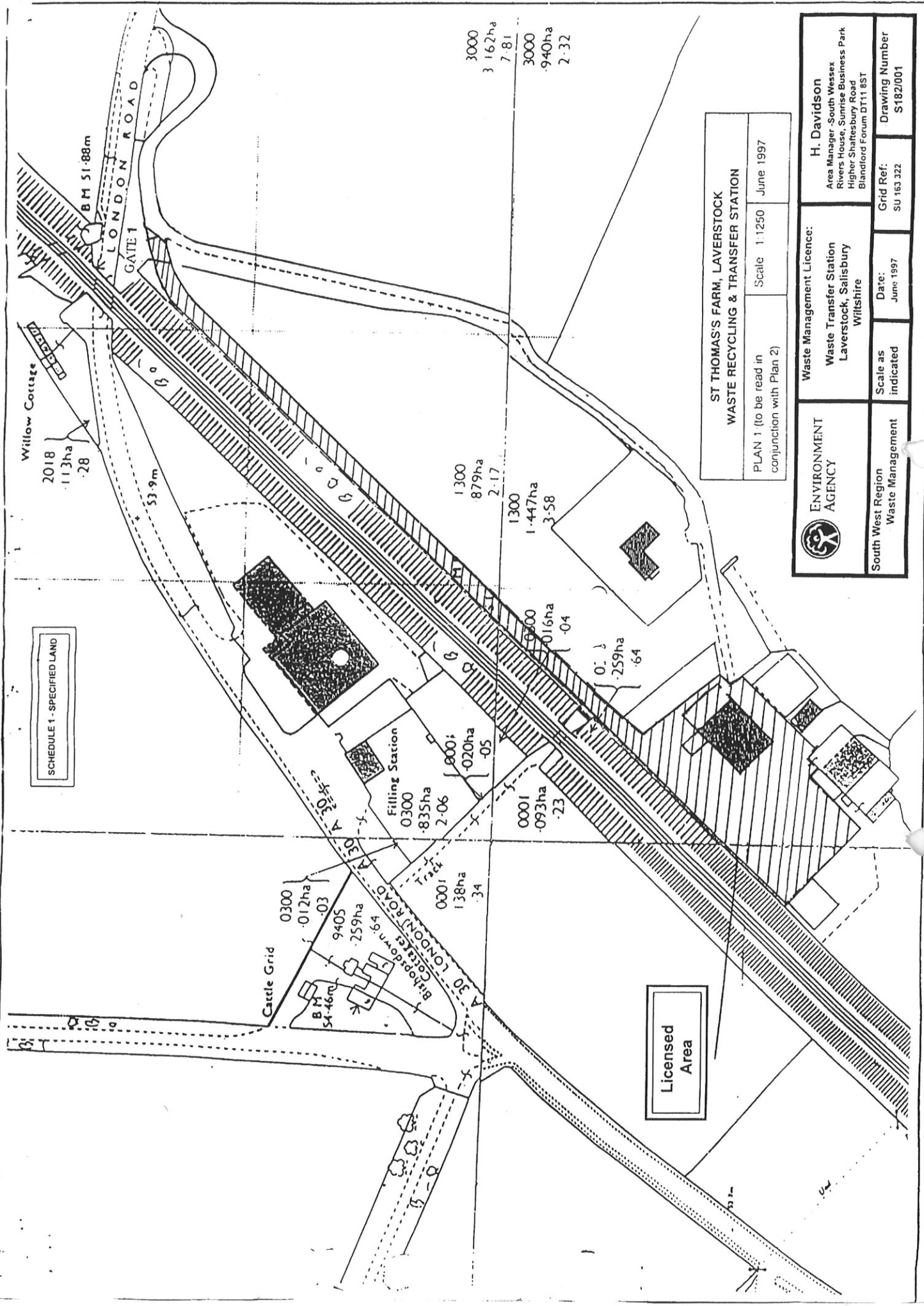

ST THOMAS'S FARM, LAVERSTOCK
WASTE RECYCLING & TRANSFER STATION
 PLAN 1 (to be read in conjunction with Plan 2)
 Scale 1:1250 June 1997

 ENVIRONMENT AGENCY South West Region Waste Management	Waste Management Licence: Waste Transfer Station Laverstock, Salisbury Wiltshire	H. Davidson Area Manager - South Wessex Rivers House, Sunrise Business Park Higher Shaftesbury Road Blandford Forum DT11 8ST
	Scale as indicated	Date: June 1997
Drawing Number S182/001		

SCHEDULE 1 - SPECIFIED LAND

Licensed Area

3000
3 162ha
7 81

1300
879ha
2 17

1300
1 447ha
3 58

0000
0 016ha
0 04

0 259ha
0 64

0000
0 835ha
2 06

0001
0 093ha
0 23

0300
0 012ha
0 03

9405
0 259ha

0001
1 38ha
0 34

BM 51 88m

2018
1 13ha
0 28

53 9m

Castle Grid

BM 54 46m

Filling Station
0300

Trade

0300
0 012ha
0 03

9405
0 259ha

0001
1 38ha
0 34

Filling Station
0300

0000
0 835ha
2 06

0001
0 093ha
0 23

0000
0 016ha
0 04

0 259ha
0 64

1300
1 447ha
3 58

1300
879ha
2 17

3000
3 162ha
7 81

3000
0 940ha
2 32

LONDON ROAD

GATE 1

0300
0 012ha
0 03

9405
0 259ha

0001
1 38ha
0 34

Filling Station
0300

0000
0 835ha
2 06

0001
0 093ha
0 23

0000
0 016ha
0 04

0 259ha
0 64

1300
1 447ha
3 58

1300
879ha
2 17

3000
3 162ha
7 81

3000
0 940ha
2 32

LONDON ROAD

GATE 1

0300
0 012ha
0 03

9405
0 259ha

0001
1 38ha
0 34

Filling Station
0300

0000
0 835ha
2 06

0001
0 093ha
0 23

0000
0 016ha
0 04

0 259ha
0 64

1300
1 447ha
3 58

1300
879ha
2 17

3000
3 162ha
7 81

3000
0 940ha
2 32

LONDON ROAD

GATE 1

0300
0 012ha
0 03

9405
0 259ha

0001
1 38ha
0 34

Filling Station
0300

0000
0 835ha
2 06

0001
0 093ha
0 23

0000
0 016ha
0 04

0 259ha
0 64

1300
1 447ha
3 58

1300
879ha
2 17

3000
3 162ha
7 81

3000
0 940ha
2 32

LONDON ROAD

GATE 1

0300
0 012ha
0 03

9405
0 259ha

0001
1 38ha
0 34

Filling Station
0300

0000
0 835ha
2 06

0001
0 093ha
0 23

0000
0 016ha
0 04

0 259ha
0 64

1300
1 447ha
3 58

1300
879ha
2 17

3000
3 162ha
7 81

3000
0 940ha
2 32

LONDON ROAD

GATE 1

0300
0 012ha
0 03

9405
0 259ha

0001
1 38ha
0 34

Filling Station
0300

0000
0 835ha
2 06

0001
0 093ha
0 23

0000
0 016ha
0 04

0 259ha
0 64

1300
1 447ha
3 58

1300
879ha
2 17

3000
3 162ha
7 81

3000
0 940ha
2 32

LONDON ROAD

GATE 1

0300
0 012ha
0 03

9405
0 259ha

0001
1 38ha
0 34

Filling Station
0300

0000
0 835ha
2 06

0001
0 093ha
0 23

0000
0 016ha
0 04

0 259ha
0 64

1300
1 447ha
3 58

1300
879ha
2 17

3000
3 162ha
7 81

3000
0 940ha
2 32

LONDON ROAD

GATE 1

0300
0 012ha
0 03

9405
0 259ha

0001
1 38ha
0 34

Filling Station
0300

0000
0 835ha
2 06

0001
0 093ha
0 23

0000
0 016ha
0 04

0 259ha
0 64

1300
1 447ha
3 58

1300
879ha
2 17

3000
3 162ha
7 81

3000
0 940ha
2 32

LONDON ROAD

GATE 1

0300
0 012ha
0 03

9405
0 259ha

0001
1 38ha
0 34

Filling Station
0300

0000
0 835ha
2 06

0001
0 093ha
0 23

0000
0 016ha
0 04

0 259ha
0 64

1300
1 447ha
3 58

1300
879ha
2 17

3000
3 162ha
7 81

3000
0 940ha
2 32

LONDON ROAD

GATE 1

0300
0 012ha
0 03

9405
0 259ha

0001
1 38ha
0 34

Filling Station
0300

0000
0 835ha
2 06

0001
0 093ha
0 23

0000
0 016ha
0 04

0 259ha
0 64

1300
1 447ha
3 58

1300
879ha
2 17

3000
3 162ha
7 81

3000
0 940ha
2 32

LONDON ROAD

GATE 1

0300
0 012ha
0 03

9405
0 259ha

0001
1 38ha
0 34

Filling Station
0300

0000
0 835ha
2 06

0001
0 093ha
0 23

0000
0 016ha
0 04

0 259ha
0 64

1300
1 447ha
3 58

1300
879ha
2 17

3000
3 162ha
7 81

3000
0 940ha
2 32

LONDON ROAD

GATE 1

0300
0 012ha
0 03

9405
0 259ha

0001
1 38ha
0 34

Filling Station
0300

0000
0 835ha
2 06

0001
0 093ha
0 23

0000
0 016ha
0 04

0 259ha
0 64

1300
1 447ha
3 58

1300
879ha
2 17

3000
3 162ha
7 81

3000
0 940ha
2 32

LONDON ROAD

GATE 1

0300
0 012ha
0 03

9405
0 259ha

0001
1 38ha
0 34

Filling Station
0300

0000
0 835ha
2 06

0001
0 093ha
0 23

0000
0 016ha
0 04

0 259ha
0 64

1300
1 447ha
3 58

1300
879ha
2 17

3000
3 162ha
7 81

3000
0 940ha
2 32

LONDON ROAD

GATE 1

0300
0 012ha
0 03

9405
0 259ha

0001
1 38ha
0 34

Filling Station
0300

0000
0 835ha
2 06

0001
0 093ha
0 23

0000
0 016ha
0 04

0 259ha
0 64

1300
1 447ha
3 58

1300
879ha
2 17

3000
3 162ha
7 81

3000
0 940ha
2 32

LONDON ROAD

GATE 1

0300
0 012ha
0 03

9405
0 259ha

0001
1 38ha
0 34

Filling Station
0300

0000
0 835ha
2 06

0001
0 093ha
0 23

0000
0 016ha
0 04

0 259ha
0 64

1300
1 447ha
3 58

1300
879ha
2 17

3000
3 162ha
7 81

3000
0 940ha
2 32

LONDON ROAD

GATE 1

0300
0 012ha
0 03

9405
0 259ha

0001
1 38ha
0 34

Filling Station
0300

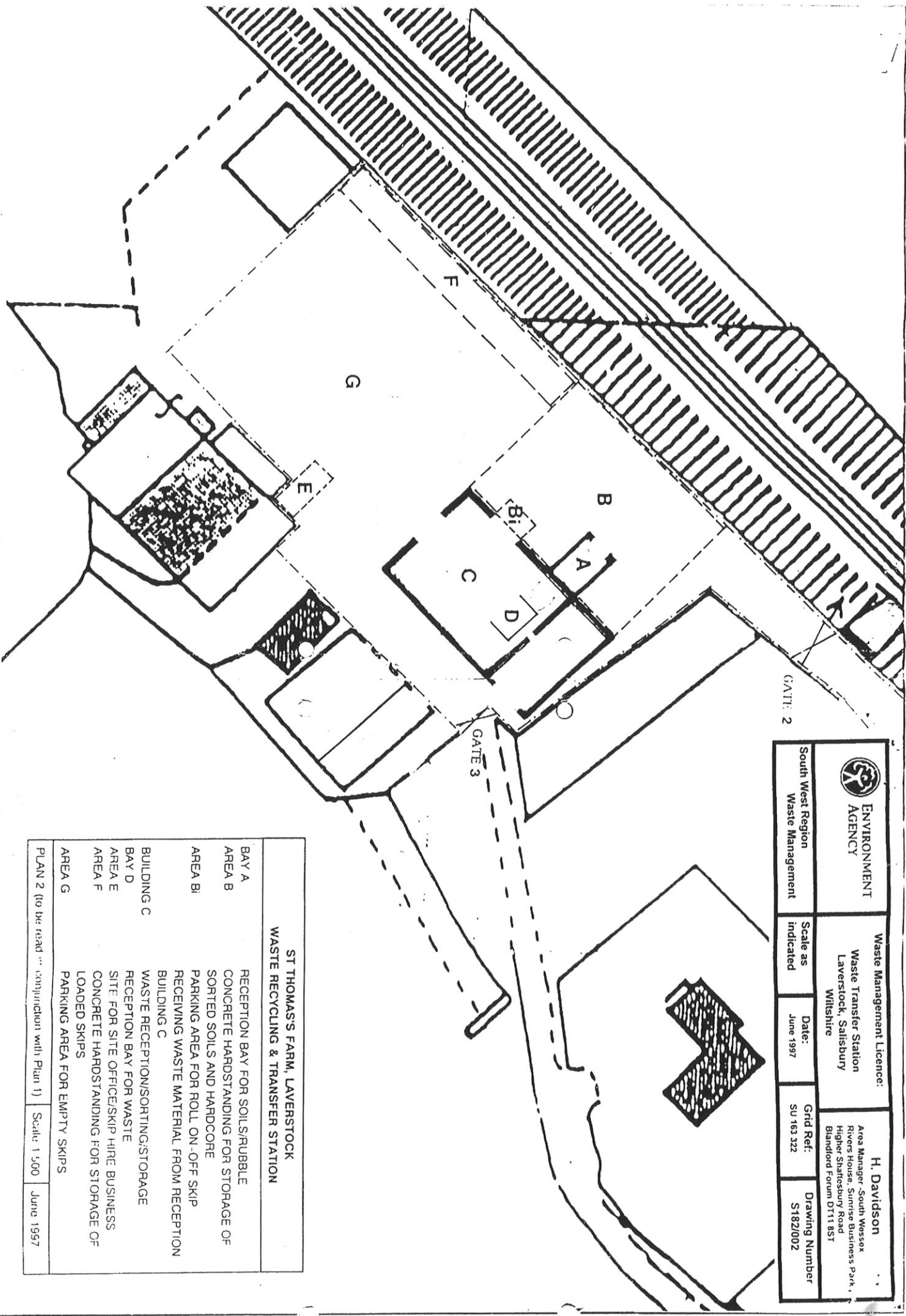

ENVIRONMENT AGENCY

South West Region
Waste Management

Waste Management Licence:
Waste Transfer Station
Laverstock, Salisbury
Wiltshire

Scale as indicated
Date: June 1997

H. Davidson
Area Manager - South Wosses
Rivers House, Sunrise Business Park,
Higher Shaftesbury Road
Blandford Forum DT11 8ST

Grid Ref: SU 163 322
Drawing Number S182/002

**ST THOMAS'S FARM, LAVERSTOCK
WASTE RECYCLING & TRANSFER STATION**

- BAY A RECEPTION BAY FOR SOILS/RUBBLE
- AREA B CONCRETE HARDSTANDING FOR STORAGE OF SORTED SOILS AND HARDCORE
- AREA BI PARKING AREA FOR ROLL ON-OFF SKIP RECEIVING WASTE MATERIAL FROM RECEPTION BUILDING C
- BUILDING C WASTE RECEPTION/SORTING/STORAGE
- BAY D RECEPTION BAY FOR WASTE
- AREA E SITE FOR OFFICE/SKIP HIRE BUSINESS
- AREA F CONCRETE HARDSTANDING FOR STORAGE OF LOADED SKIPS
- AREA G PARKING AREA FOR EMPTY SKIPS

PLAN 2 (to be read in conjunction with Plan 1) Scale: 1:500 June 1997

